From: 18 September 2010 14:40
Sent: 'licensing@plymouth.gov.uk'
To: Waterfront Licence Variation 024149.
Subject:

For the Attention of: Mr Peter Clemens, Licensing Officer, Plymouth Council.
With Reference to the Application for Variation Licence 024149 I wish to record my objection to any extension of hours principally with regard to outdoor amplified music, NO amplified external music should be permitted. The Hoe is a very special area to Plymouth both for residents and visitors and the Council through their officers should ensure that the ambience of this area is fully protected. I accept that the business associated with the Waterfront with regard to permitting controlled time periods for consumption of alcohol, refreshments and music entertainment should be permitted to make the business viable however this must be carefully controlled.

Flat 10 Grand Parade PLYMOUTH PL1 1 1 1 1

Yours faithfully

RECEIVED
PUBLIC PROTECTION SERVICE
21 SEP 2010
F.A.O.

RECEIVED
PUBLIC PROTECTION SERVICE
21 Sep 2010

Grand Parade
West Hoe
Plymouth
PL1
18/9/10.

To ~~Whom~~ It may concern,

As a resident of Grand Parade I am objecting to the proposed opening times changes and licence for music to be played OUTSIDE The Waterfront Bar and Restaurant.

Grand Parade is a residential Area where many of the residents are enjoying a quiet retirement (myself included) we do not want to be kept awake seven nights a week listening to loud music.

If a music licence is granted it should be for indoor performances only and all windows and doors closed except for occasional performances where a special licence can be applied for and three weeks notice posted for all residence to see and each performance to finish at 10.00pm.

It would be a travesty if this beautiful venue be permitted to spoil the tranquility and decent living of all the residents not only in Grand Parade but also those living in the surrounding areas.
Yours faithfully

Hoe Road
Plymouth
Devon
PL1
20/09/2010

Licensing Dept
P.C.C
Civic Centre
PL1 2EW

Dear Sir/Madam,

I am writing to you in regards to the proposed licensing changes to the Waterfront Bar/Restaurant which is situated adjacent to The Wet Wok on the Hoe.

I have no objections to the extension of the opening hours but I am very concerned and strongly object to the any live entertainment outside of the property. On at least three occasions recently, the last being the weekend of the 18th & 19th of September, the live music that was being played was of such high volume I could hear it inside of my restaurant, over my own ambient background music, even with all the windows closed. I had to deal with a number of complaints from my customers, not only for the volume of their music but also with having the windows closed on a warm September evening.

The property is situated in such a lovely spot that many customers regularly return for this beautiful vista which is complemented by soft background music creating an ambience in which people can eat and talk in relative peace. On all the occasions The Waterfront has had the outside entertainment this wasn't possible and I feel I will lose customers because of this.

In fact I believe that loud, blaring music will ruin the whole area of Plymouth Hoe and is unbecoming to what people expect when they come to visit our War or Historic monuments.

I look forward to hearing from you,

Yours Sincerely,

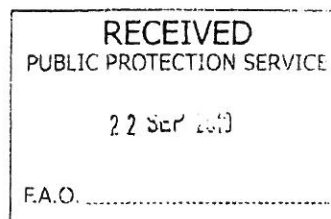

Grand Parade
W Hoe
Plymouth
PL1 3DF
01752

The Licensing Department
Plymouth City Council
Civic Centre
Plymouth
PL1 2EW

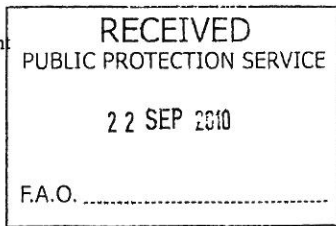

20th September 2010

Dear Sirs

Licensing Application 024149 The Waterfront, 9 Grand Parade PL1 2PA

Plymouth Hoe is one of the finest outdoor settings in Great Britain where the Residents of West Hoe and the people visiting the Hoe can, for most of the year enjoy peace and tranquillity whilst looking out to sea. We also enjoy the diversity of events which take place but we expect our Council to stop the Hoe turning into a mini 'Lager Lout' area for rest of the year.

The Waterfront is asking for the legal right to play loud outdoor music until midnight. With the music comes dancing, singing, drunkenness and on occasions jumping into the sea this is defiantly a Public Nuisance and if some one dives off the rocks and injures themselves or drowns, a Public Safety issue.

The Waterfront has no regard for the residents as they play their music at a volume that can be heard over ½ mile away (on a walk we could hear music on the far side of Smeatons Tower) rather than just loud enough so that only their patrons can hear and enjoy it.

I have sent copies of this letter to our local councillors as they, at this time, are the custodians of Plymouth Hoe. I trust that they will not let us the residents, who have elected them, down. I trust that they will contact many of us so that they can get a good cross section of opinions.

Having music up to midnight in a mainly residential area is wrong. I and many of my neighbours will be at the hearing to make our views known.

Yours truly

Grand Parade
West Hoe
Plymouth
PL1

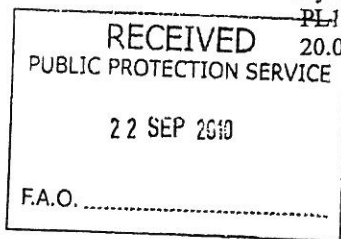

The Licensing Department
Plymouth City Council
Civic Centre
Plymouth
PL1 2EW

Re: Licensing application 024149
The Waterfront, 9 Grand Parade, West Hoe, PL1 2PA

Dear Sir, Madam

We have lived on Grand Parade for over 20years before a Licence was issued to St Austell Brewery. West Hoe is historically a quiet residential district in a Conservation area, this application, if granted, could change completely the neighbourhood that we live in.

We want to be able to live in an area where we are able to open our windows, without constantly bombarded with loud music for 9-10hrs per day i.e. from 12.30 – 1.00pm lunch time until dark at night, as happened last weekend. When the weather is warm as it was this summer we need to be able to open the windows for ventilation.

At present when inside with closed windows there is no where to go to get away from the noise. If you go for a walk up on the Hoe and beyond the music follows you and on some days the Waterfront can be competing with some other event which makes it even worse and leaves one with a headache because it is so stressful.

We are not setting out to stop families enjoying the Hoe, as they have always done; we just want to be able to live in our homes in relative peace and quiet.

There is also the matter of the hours having recently been extended which was a surprise to us as we were completely unaware of any application having been made, we did not see a notice displayed. The extended hours is an opportunity for people who have already been to some other venue to come to the Waterfront because they are still open, leading to increased drunkenness or even jumping into the sea. This may seem fun when you

have had a few drinks but when dark and you are unable to see the rocks
may not be such a good idea.

The extra noise late at night or early morning makes having the windows
open at all difficult with car doors banging and people saying their goodbyes
etc. Most people have no idea of how noise travels upwards; you can hear
conversations quite clearly, making it difficult to get to sleep at a reasonable
hour. People who are working or older people like to go to sleep by at least
11.30 – 12mn if not sooner.

I personally feel that my basic right to be able to live quietly in my own
home has been threatened.

Yours sincerely

**GRAND PARADE
PLYMOUTH PL1**

Tel: 01752. Mobile:

22 September 2010

The Licensing Department
Plymouth City Council
Civic Centre
Plymouth PL1 2EW

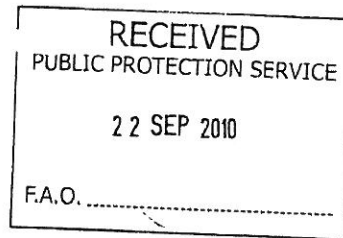

Dear Sir/Madam

Re: The Waterfront Restaurant – Licensing Application 024149

On behalf of my wife and myself I would like to make representations concerning the above application to vary the licence. We are interested parties as our house is immediately opposite and overlooking the premises.

This is the third time I have made representations concerning this licence, and the brewery, with successive tenants, are repeating several requests for variation to which there was considerable opposition before.

PUBLIC NUISANCE

NOISE – We are opposed to any outside entertainment, including amplification from inside through an external speaker system. Our request to prohibit this is based on the fact that:

- (a) We can hear loud laughter, etc, from clients on the outside areas of the premises and any entertainment would presumably be much louder than that. Planning conditions on these premises state "no public address or other sound amplification system shall be installed on the outside of the premises" (Notice/plan No 1346/88.)
- (b) Several events have occurred since the change of tenancy. We were away for the first ones but neighbours informed me the noise was horrendous.
- (c) On 18/19 September there was an outdoor event when the noise emanating from The Waterfront was louder inside our lounge, with double glazed windows shut, than that of the normal volume of our television. The noise was extremely stressful and certainly not in the previous corporate plans of the City of Plymouth to improve the health of local people like ourselves. The management of the Waterfront on this occasion showed that it was either unaware of, or unwilling to comply with, existing conditions laid out by the Licensing Committee on 22/8/05 (condition 4h "..... noise emanating from the premises will not be clearly audible 1 meter from the façade of the nearest residential property").

USE OF CAR PARK – On 18/19 September the car park of The Waterfront contained an outside catering van, an ice-cream van, and a burger barbecue with the remaining space filled with plastic tables and chairs. This was in contradiction of conditions laid down in the Planning Notice No 1346/88, which states “the land for the parking of vehicles shall not be used for any other purpose” Although this is a planning contravention, we believe it to be relevant as the noise of people leaving (car doors slamming, etc) is greater when vehicles are displaced to the road nearer to our home.

EXTENSION OF OPENING HOURS – We would prefer the closing times to be as early as possible so any noise causes minimum disturbance.

Thank you for considering our views which are summarised as follows:

- No outside entertainment
- Retain car parking area
- Closing times to be relevant to a quiet residential area.

Yours faithfully

**Custom House Lane,
PLYMOUTH, PL1
Tel: 01752**

19th September 2010

The Licensing Department,
Plymouth City Council,
Civil Centre,
PLYMOUTH,
PL1 3TG.

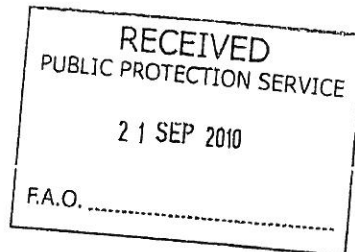

Dear Sirs,

Licensing Application No.024149 The Waterfront Bar & Restaurant, West Hoe

We live in West Hoe and we wish to object strongly to the current application.

Incidentally, despite walking past the Waterfront everyday, we were not aware of the application which resulted in the current licence being granted on 29th July last. We would certainly have objected that the hours of the current alcohol and music licence are inappropriately late for a residential area. You may wish to investigate where the required notice was posted.

The current licence application seeks

- To have outdoor music and dancing rather in addition to indoor
- To extend the existing music and dancing licence from 11pm to midnight
- To extend the selling of alcohol until midnight during the week and to unspecified times at the weekends

The City Council and the Police are well aware of the problems previously caused in West Hoe at night by noise, drunkenness, slamming of car doors, racing of cars, prostitution and general unruly behaviour. Both parties have done a great deal in recent years to eliminate these nuisances.

We also understand that it is the Council's policy and the Police's wish that late night entertainment premises should be constrained to designated areas of the City.

This licence application is clearly in breach of that wish.

The West Hoe is a quiet residential and Conservation area totally unsuitable for such a venue with the facilities sought in this licence application.

Outdoor music and dancing late at night will cause significant nuisance to the residents - and to the visitors staying in the local small hotels.

Additionally there will be inevitably slamming of car doors, revving of engines, shouting revellers and general drunkenness late at night.

The approval of the licence will lead to other revellers coming to the area with consequent public nuisance and the likelihood of increased crime and disorder.

The successful efforts of the Council and the Police to limit and control the problems of the past will be absolutely negated.

We request therefore that the licence application is refused in respect of

- music and dancing outside
- extension of the existing alcohol, music and dancing licence beyond the current hours.

Yours faithfully

From:
Sent: 13 September 2010 17:03
To: Licensing (DEVELOPMENT)
Subject: Waterfront public house and restaurant

I understand that the Waterfront Public House is applying for a licence for late night music etc outside the building.

If this is correct I would like to object. This is predominantly a residential area and the noise would be a problem for many residents. The premises are large enough for any music and other events to be held inside the building thus minimising any problems to residents.

Flat , Grand Parade, Plymouth.

Mr
Pier Street
West Hoe
Plymouth
PL1
Tel 01752

RECEIVED
PUBLIC PROTECTION SERVICE
21 SEP 2010
F.A.O.

Licensing Department
Civic Centre
Plymouth
PL1 2EW

20th September 2010

Dear Sir

The Waterfront Bar and Restaurant, West Hoe

I have been made aware that there is a statutory notice whereby the licensee of the Waterfront Restaurant has applied for an extension of entertainment licence to his establishment. I write to record my opinions as a local resident who lives 40 metres from the entrance to the Restaurant.

I would fully support the licence application. Whilst the Restaurant was without a licence from January to June 2010 the area became lifeless and run down. Rubbish started to accumulate, tramps started to sleep rough in the area, unlicensed parties were a regular occurrence and the waterfront in that area took on the appearance of down town Beirut in the 1980s.

Since the Waterfront gained a licensee the whole environment has changed. Life has been brought back to a wonderful Plymouth setting. It is clean and tidy and now it is well used and a credit to the city. Visitors are now drawn to the area and at a guess employment is now been given to at least 10 to 15 young people who serve at the bar and at table, as well as chefs in the kitchen.

I would fully support the licensee in his application. I truly hope that the objections of a tiny minority will not prevent the establishment of the business that brings employment and visitors to the local area. Plymouth needs businesses such as this, run by local and considerate people, to enhance the natural grandeur of Plymouth Sound and Plymouth Hoe.

Yours Sincerely

EXISTING

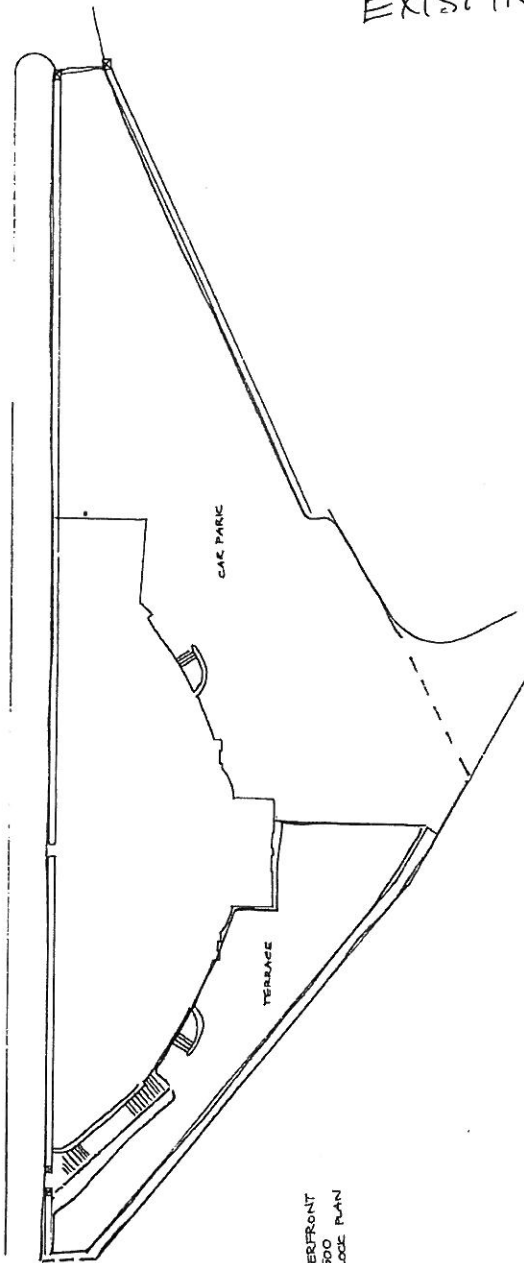

WATERFRONT
1:500 PLAN
BLDG PLAN

APPENDIX 38

PROPOSED

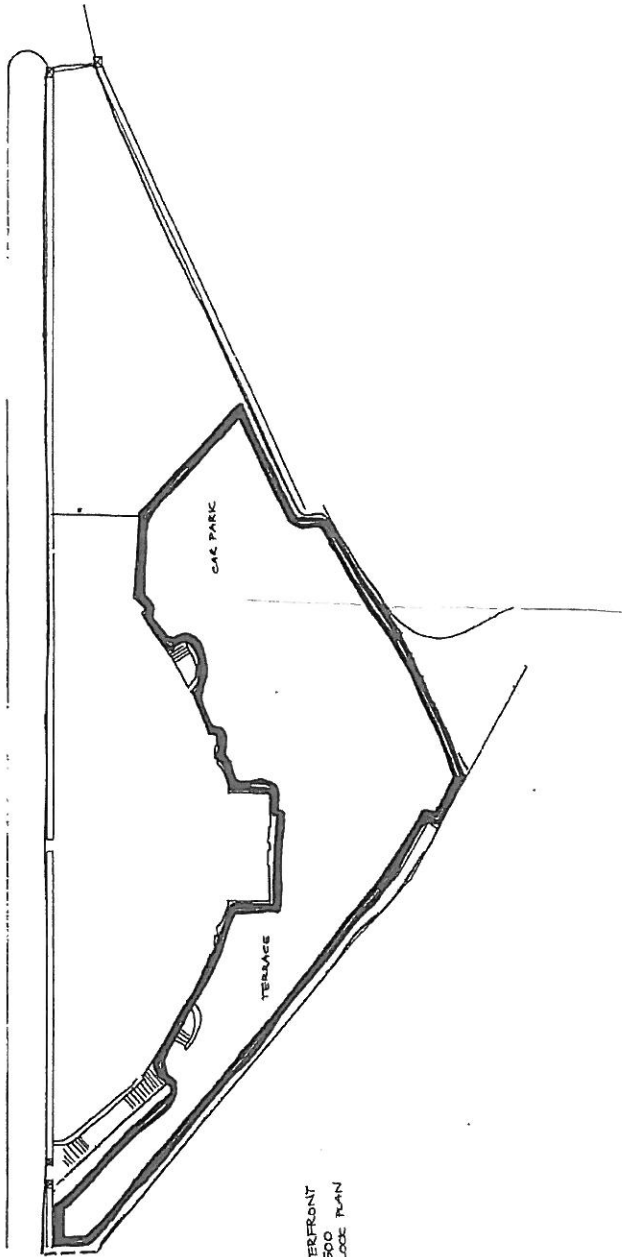

WATERFRONT
1:500
BLOCK PLAN